

## 1. SPECIFICATION

|                                    |                   |
|------------------------------------|-------------------|
| FREQUENCY RANGE                    | 25.000-150.000KHz |
| LOAD CAPACITANCE                   | 12.5PF TYPICAL    |
| FREQUENCY TOLERANCE AT 25°C        | -/+30PPM MAXIMUM  |
| OPERATING TEMPERATURE RANGE        | -10 TO +60 °C     |
| STORAGE TEMPERATURE RANGE          | -40 TO +85 °C     |
| EQUIVALENT SERIES RESISTANCE (ESR) | 40Kohm MAXIMUM    |
| DRIVE LEVEL                        | 1.0 i W MAXIMUM   |
| SHUNT CAPACITANCE                  | 1.7PF MAXIMUM     |
| AGING                              | -/+5PPM PER YEAR  |
| INSULATION RESISTANCE              | 500Mohm MINIMUM   |

## 2. PART NUMBERING SYSTEM

| HOLDER TYPE | FREQUENCY | LOAD CAPACITANCE | FREQUENCY TOLERANCE AT 25°C |
|-------------|-----------|------------------|-----------------------------|
| TF38        | IN KHz    | 6 TO 12.5PF      | 20 FOR<br>-/+20PPM          |

|                             |
|-----------------------------|
| OPERATING TEMPERATURE RANGE |
| B FOR -10 TO +60 °C         |

12.5PF OF LOAD CAPACITANCE NOT NEEDED IN PART NUMBER  
 20PPM OF FREQUENCY TOLERANCE NOT NEEDED IN PART NUMBER  
 -10 TO +60 °C OF OPERATING TEMPERATURE RANGE NOT NEEDED IN PART NUMBER

## 3. DIMENSIONS

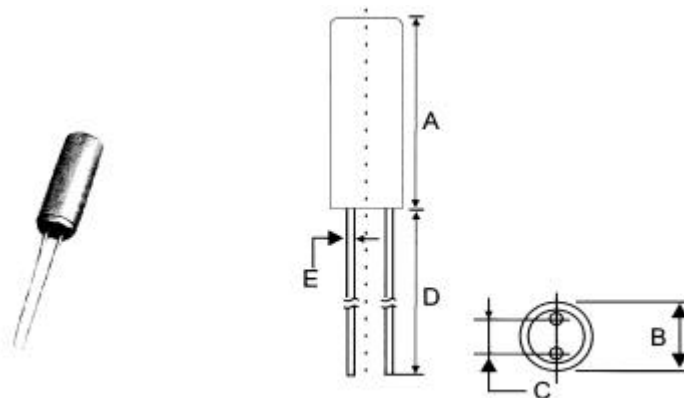

| A   | B     | C   | D    | E     |
|-----|-------|-----|------|-------|
| 8.0 | φ 3.0 | 1.1 | 10.0 | φ 0.3 |