



TRR

MAIN FEATURES

- Miniature, cost-effective switching solution.
- State of the art capsule designs.
- Molded construction for compatibility with automatic board processing.
- Epoxy-molded dual-in-line package.
- UL and cUL recognized.



APPLICATIONS

Measuring equipment, Communication equipment, Control equipment, Appliances, etc.

ORDERING INFORMATION

Type: TRR — 1A — 05 — D — 00 — D — R

Nominal Coil voltage: 05 : 5VDC, 12 : 12VDC, 24 : 24VDC
 Function: NIL : Standard, D : Diode, M : Magnetic shield, X : Magnetic shield and Diode
 R : RoHS Compliant
 Add suffix "R" for RoHS compliant only use for order identify not use for safety certified

Contact Arrangement: 1A : 1 Form A, 1B : 1 Form B, 1C : 1 Form C, 2A : 2 Form A
 Package: F : SIP Type, D : DIP Type, S : SMD Type
 Special Code: 00, 10, 20, 30, 50

Package	Coil Pin	Contact Pin	1A	1B	1C	2A	Special Code
SIP	4 Pin	3,5	1,7	00	--	--	--
SIP	4 Pin	2,6	1,7	50	--	--	--
DIP/ SMD	8 Pin	2,6	1,7,8,14	00	00	00	--
DIP/ SMD	8 Pin	(2&13),6	1,7,8,14	10	10	10	00
DIP	4 Pin	2,6	8,14	20	--	--	--
DIP	8 Pin	6,13	1,7,8,14	30	--	--	--

DIMENSION (unit:mm) DRILLING (unit:mm) WIRING DIAGRAM

SIP Type
TRR-00
(00-PIN OUT 1,3,5,7)

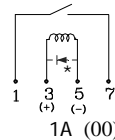
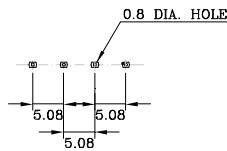
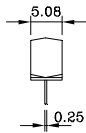
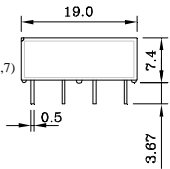

TRR-50
(50-PIN OUT 1,2,6,7)

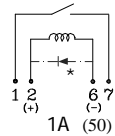
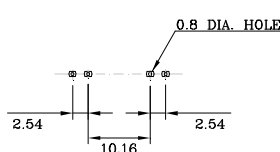
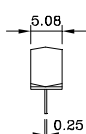
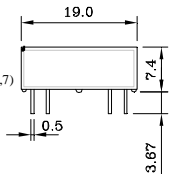

(*With Diode Type Options)

DIP Type

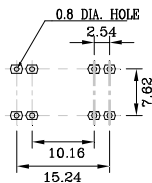
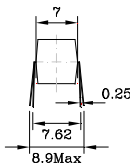
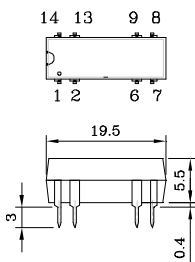

(10) Pin-Out With #13, (00) Pin-Out With W/O #13.

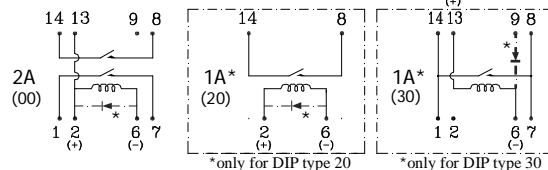
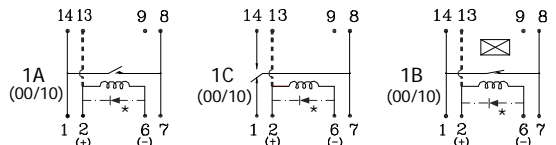

(*With Diode Type Options)

Please kindly indicate special code.

Remark: 1.In case of no tolerance shown in dimension: ±0.5mm.
2.The tolerance without indicating for DRILLING is always ±0.1mm.

DIMENSION(unit:mm)

DRILLING(unit:mm)

WIRING DIAGRAM

SMD Type

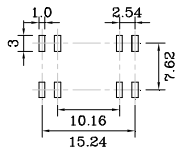
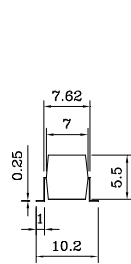
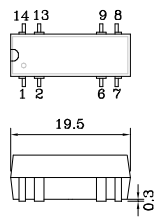

(10) Pin-Out With #13, (00) Pin-Out With W/O #13.

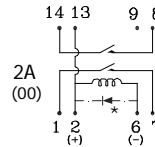
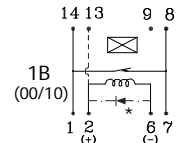
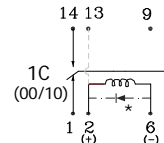
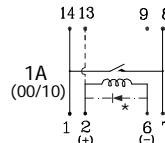

Remark: 1.In case of no tolerance shown in dimension: ±0.5mm.
2.The tolerance without indicating for DRILLING is always ±0.1mm.

Please kindly indicate special code.

(*With Diode Type Options)

COIL DATA CHART(at 20°C)

Coil Sensitivity	Nominal Voltage (VDC)	Operate Voltage Max. (VDC)	Nominal Current (mA)	Coil Resistance (Ω)±10%	Power Consumption (mW)	Pull-In Voltage (VDC)	Drop-Out Voltage (VDC)
TRR -1A TRR -1B	5	6	10	500	50	3.75	0.8
	12	14.5	12	1000	144	9.0	1.0
TRR -1C	24	29	11.2	2150	268	18.0	2.0
	5	11	25	200	125	3.75	0.8
TRR -1C	12	20	24	500	288	9.0	1.0
	24	32	11.2	2150	268	18.0	2.0
TRR -2A	5	11	35.7	140	179	3.75	0.8
	12	20	24	500	288	9.0	1.0
	24	32	11.2	2150	268	18.0	2.0

*Only for SIP type.

REFERENCE DATA

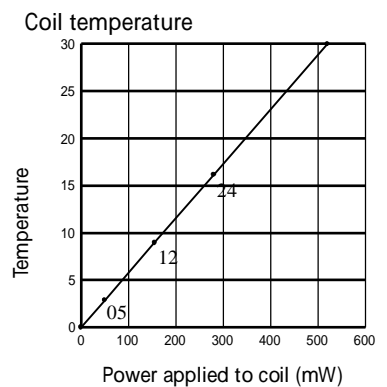

PERFORMANCE

Contact form	1A / 1B / 2A	1C
Switching Current	0.5ADC Max.	0.2ADC Max.
Carry Current	1.0ADC Max.	0.5ADC Max.
Switching Power	10VA Max.	3VA Max.
Electrical Life	1×10 ⁸ (10VDC 10mA)	5×10 ⁷ (5VDC 1mA)
Contact Resistance	150mΩ Max.	
Operation Time (including bounce time)	1.0msec. Max.	
Release Time (including bounce time)	1.0msec. Max.	
Maximum Voltage	100VDC Max.	
Insulation Resistance	10 ⁹ Ω Min.	
Dielectric Strength Between coil & contact Between contacts	1400VDC, (4000VDC Only for DIP type 20) 250VDC	
Temperature Range Operating Temp. Storage Temp.	-40 to +85°C -55 to +125°C	
Shock Resistance	30G Min.	
Weight	abt. 1.8grs	
UL & cUL	E156521	

Time Characteristic (Operate Time)

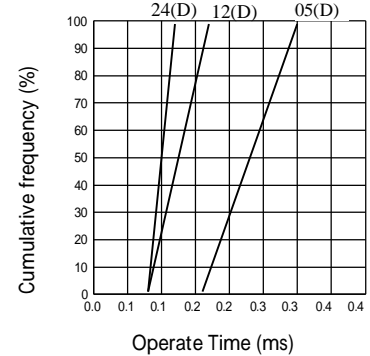

Time Characteristic (Release Time)

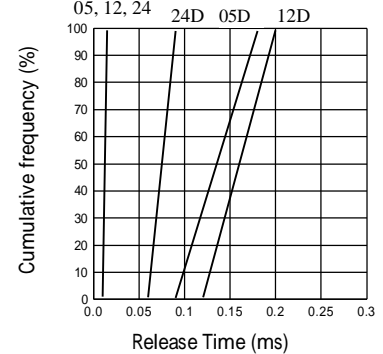

This datasheet for reference and subject to change without notice. Please double check national specification with Taiwan Shing. (0939AA08VOL01)

RADIOTECH

Tel.: (495) 795-0805

E-mail: info@rct.ru

Web: http://www.rct.ru