

REV.	DESCRIPTION	DRAWN	CHECKED	APPROVED

- NOTES:
- MATERIAL
    - INSULATOR:PBT(UL 94V-0).
    - CONTACT MATERIAL:COPPER ALLOY.
  - SPECIFICATION
    - CURRENT RATING:1.5 Amp.
    - INSULATION RESISTANCE:1000MΩ Min.
    - DIELECTRIC WITHSTANDING:600VAC.
    - CONTACT RESISTANCE:50mΩ Max.
    - OPERATING TEMPERATURE:-40°C TO+105°C.
  - PART NUMBER: DS1030-02
  - PRODUCT NUMBER CODE:  
DS1030-02 - X X X X X X

TABLE A:

TYPE	Dimension		
	A	C	B
1	3.20	9.60	2.20
2	4.00	5.70	2.80
3	3.00	22.00	3.00
4	6.00	10.40	3.00
5			
6			
7			
8			
9			
10			
11			
12			
13			
14			

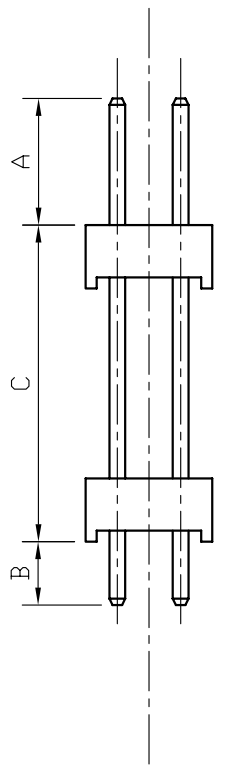
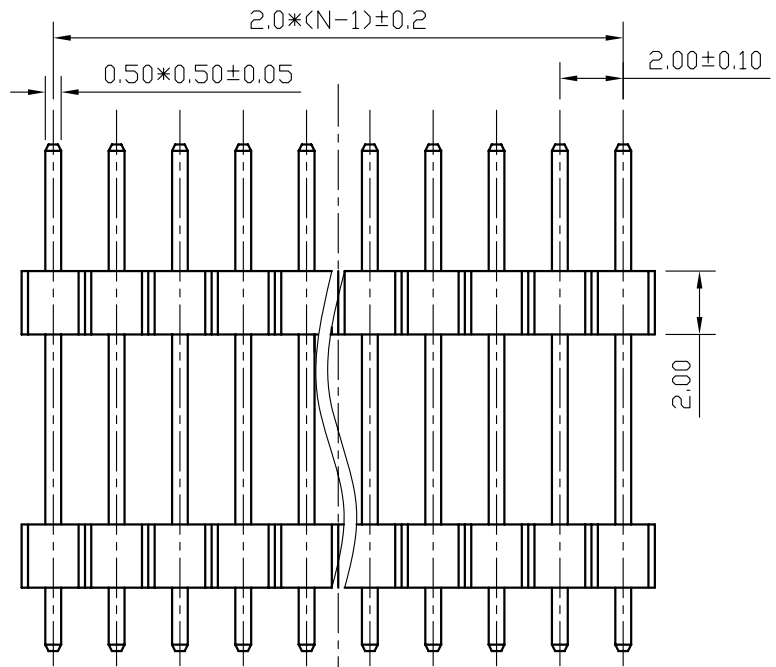
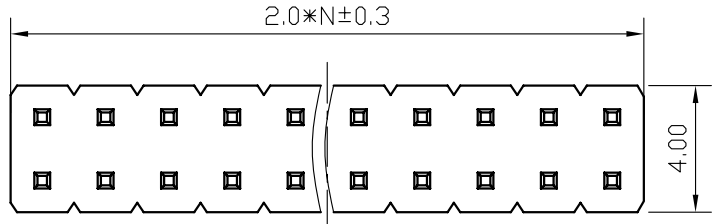
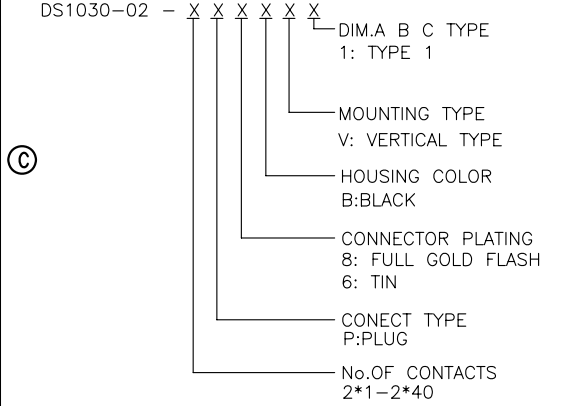

N: HALF OF CONTACTS  
A&B&C: CUSTOMER LENGTH AVAILABLE

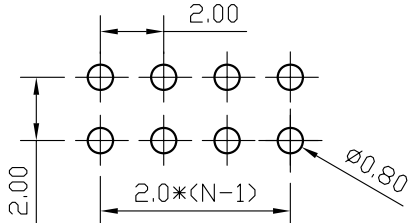

RECOMMEND PCB LAYOUT(TOLERANCE=±0.05)

GENERAL TOLERANCE		ANGLE TOLERANCE		PROJECTION		TITLE	DUAL ROW STRAIGHT	
X.	±0.60	X.	±5'	UNITS	mm	SERIES	DS1030-02 SERIES	
.X	±0.38	.X	±3'	SHEET SIZE	A4		PLHD2-80 1030-02	
.XX	±0.25	.XX	±2'	DRAWING TYPE		CUSTOMER		
SCALE				1:1	SHEET		1 OF 1	
DRAWING NO.				C-DS1030-02-XXXXXX				

2	CONTACT			
1	HOUSING			
ITEM	PART NAME	PART NO.	MATERIALS	FINISHED